

S833/2041/MO1

S833/2042/OMO1

From: Stephen Hargreaves
Sent: 27 April 2015 18:30
To: Local Plan Review
Subject: Local Plan Review, Representations: Land to the east of Greenaway, Morchard Bishop and Land at Tatepath Farm, Morchard Bishop

Dear Sirs

I am instructed by my clients, Mr & Mrs Jeffery, to submit amended suggestions for the lands they own above.

Under current policy proposals MO1, the land at east of Greenaway is to be allocated for 20 dwellings with 30% affordable housing. However, after much research, we would like to make an alternative suggestion.

There is a need for warden controlled sheltered housing local to Morchard Bishop and surrounding villages, as elderly relatives of working families find that they can only be accommodated as far away as Hatherleigh and at even greater distances apart. Increasingly, the elderly are housed in high maintenance houses that can often be far larger than they require or can support. The bills get ever higher and the maintenance more necessary and expensive. If there is also physical or mental health difficulties, the housing burden becomes a great worry and a burden to the whole family. The answer is to provide sheltered housing within the local compass of the whole family.

The site east of Greenaway is situated opposite the doctor's surgery and adjacent to the bus terminus and is therefore a natural selection for a sheltered housing development site including warden accommodation.

That then bumps the cross-subsidised affordable housing site to elsewhere and we would suggest that this would sensibly be the land currently occupied by the farm buildings on the north edge of the village, previously submitted as Site 2, Tatepath Farm.

I would welcome the opportunity to discuss this innovative and much supported land use with you at your convenience and in the meantime we would be grateful for it's inclusion in the Local Plan Review.

Yours faithfully

Stephen Hargreaves BA Dip Arch RIBA
Hargreaves: architecture+design



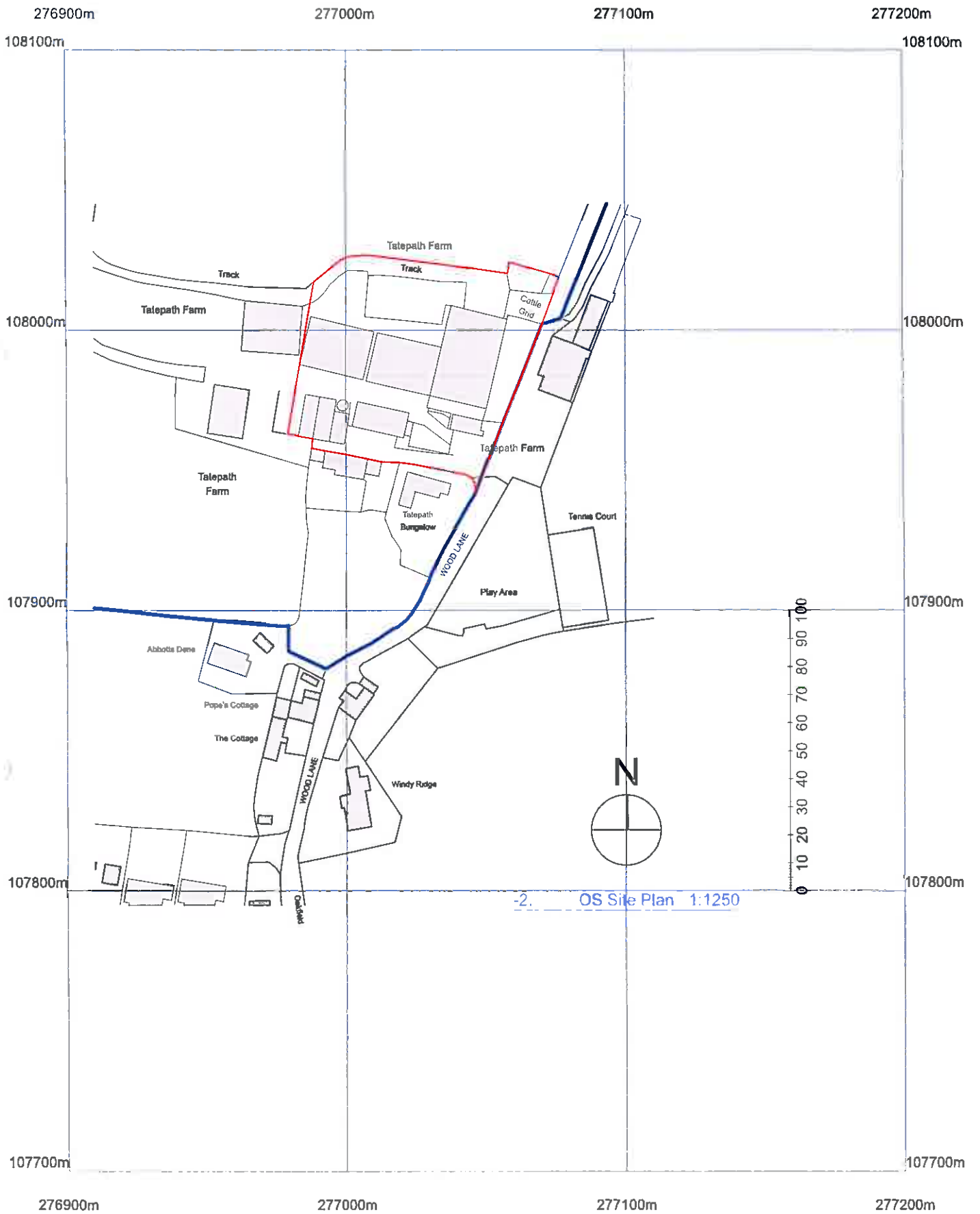

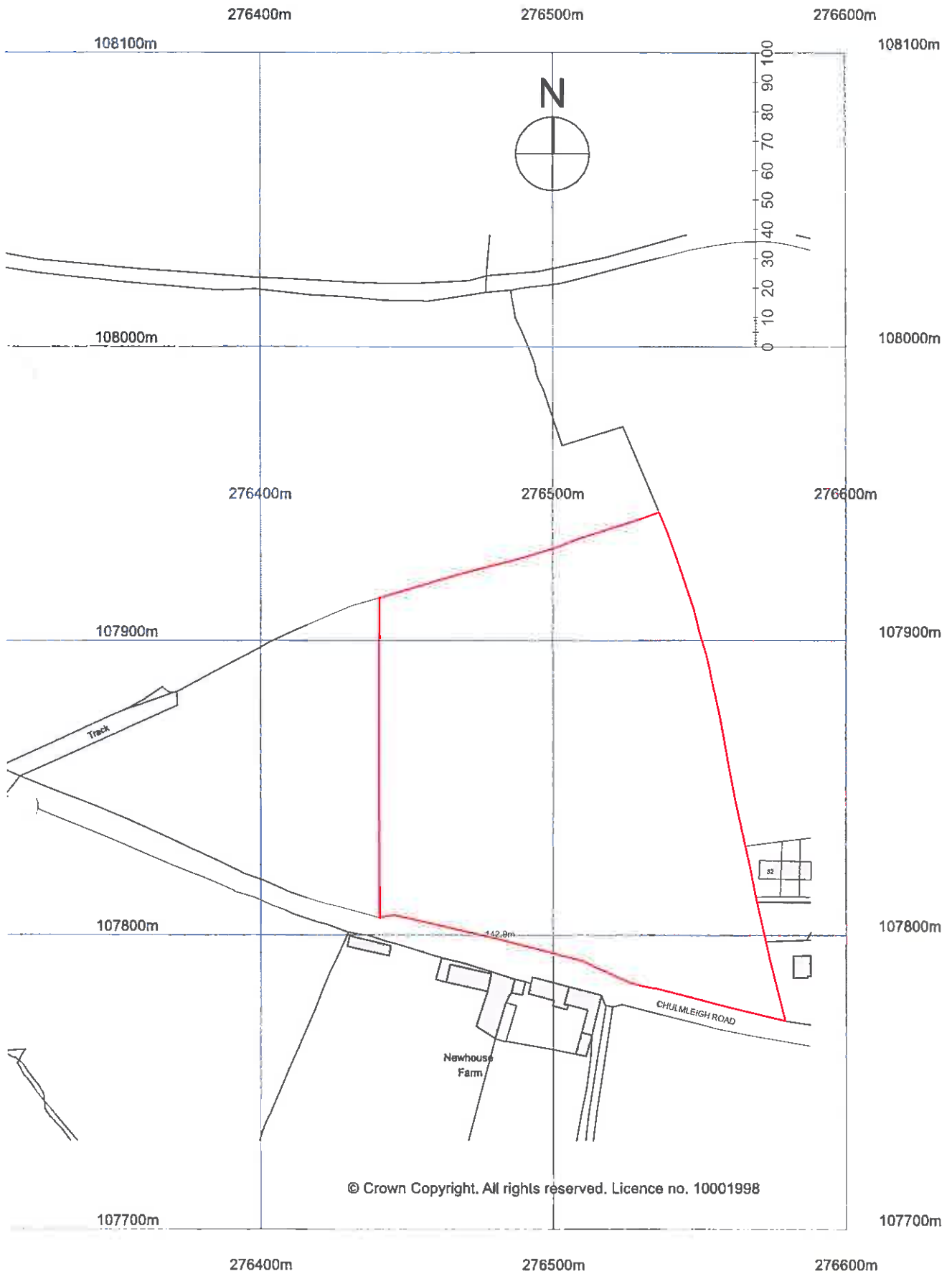

Monday, 27 April 2015

Forward Planning
Mid-Devon District Council
Phoenix House
Phoenix Lane
Tiverton
Devon
EX16 6PP

Dear Sirs,

Re: Local Plan Review

**Land East Of Greenaway, Morchard Bishop, Crediton, Devon Ref: AL/MB/1
and Site 2, Tatepath Farm, Morchard Bishop, Crediton, Devon**

I am instructed by my clients, Mr & Mrs Jeffery, to submit amended suggestions for the lands they own above.

Under current policy proposals MO1, the land at east of Greenaway is to be allocated for 20 dwellings with 30% affordable housing. However, after much research, we would like to make an alternative suggestion.

There is a need for warden controlled sheltered housing local to Morchard Bishop and surrounding villages, as elderly relatives of working families find that they can only be accommodated as far away as Hatherleigh and at even greater distances apart. Increasingly, the elderly are housed in high maintenance houses that can often be far larger than they require or can support. The bills get ever higher and the maintenance more necessary and expensive. If there is also physical or mental health difficulties, the housing burden becomes a great worry and a burden to the whole family. The answer is to provide sheltered housing within the local compass of the whole family.

The site east of Greenaway is situated opposite the doctor's surgery and adjacent to the bus terminus and is therefore a natural selection for a sheltered housing development site including warden accommodation.

That then bumps the cross-subsidised affordable housing site to elsewhere and we would suggest that this would sensibly be the land currently occupied by the farm buildings on the north edge of the village, previously submitted as Site 2, Tatepath Farm.

I would welcome the opportunity to discuss this innovative and much supported land use with you at your convenience and in the meantime we would be grateful for it's inclusion in the Local Plan Review.

Yours faithfully

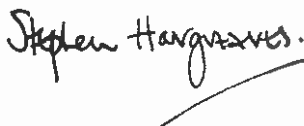

**Architect
Stephen Hargreaves BA Dip Arch RIBA**

